

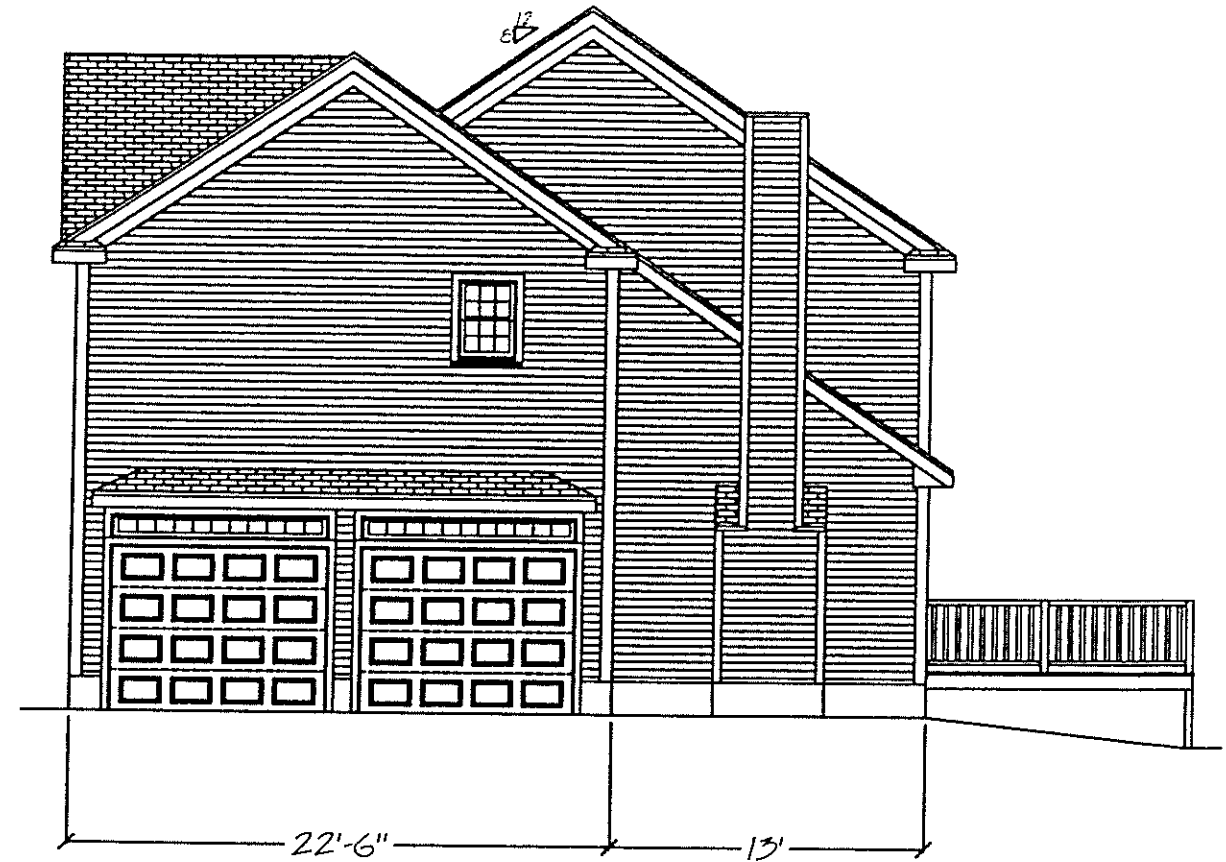

Front Elevation
Scale: 1/8" = 1'0"



Right Elevation
Scale: 1/8" = 1'0"

Heritage Builders Inc.
49 Silva Lane
Dracut, MA 01826

NOTE: These plans are intended for the use of a licensed contractor. It is the responsibility of the contractor to verify compliance with all local building codes. Homeowner/contractor to verify dimensions, proposed layout and building materials to be used prior to proceeding with construction.

SHEET # 1 of 11	Date 7/8/14	REV. 10/14
Total Living Area Sq Ft	Drawn by KK	
Desc. New Construction	Checked by	
Project.		
<p>2 Rosario Way Burlington, MA 01803</p>		



Rear Elevation
Scale: 1/8" = 1'0"

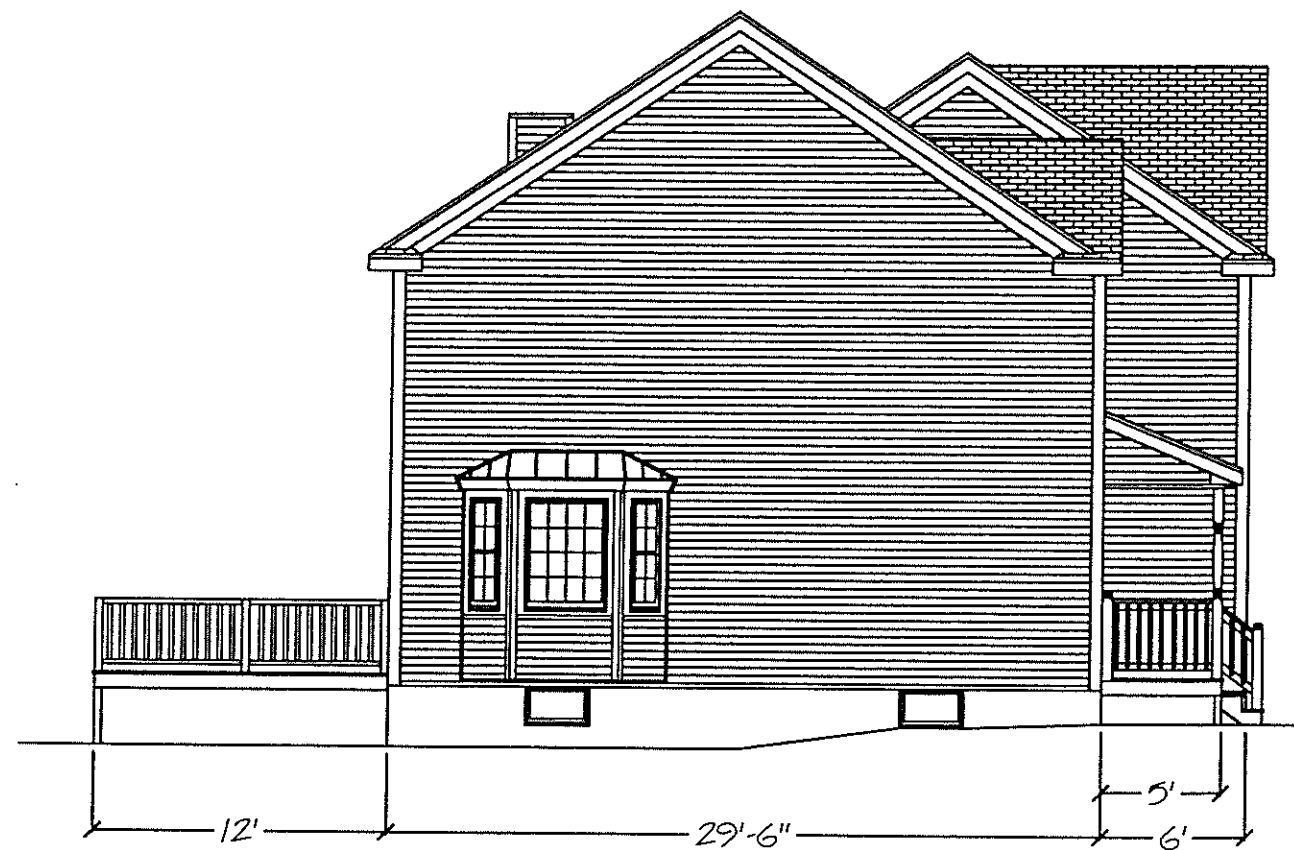

Left Elevation
Scale: 1/8" = 1'0"

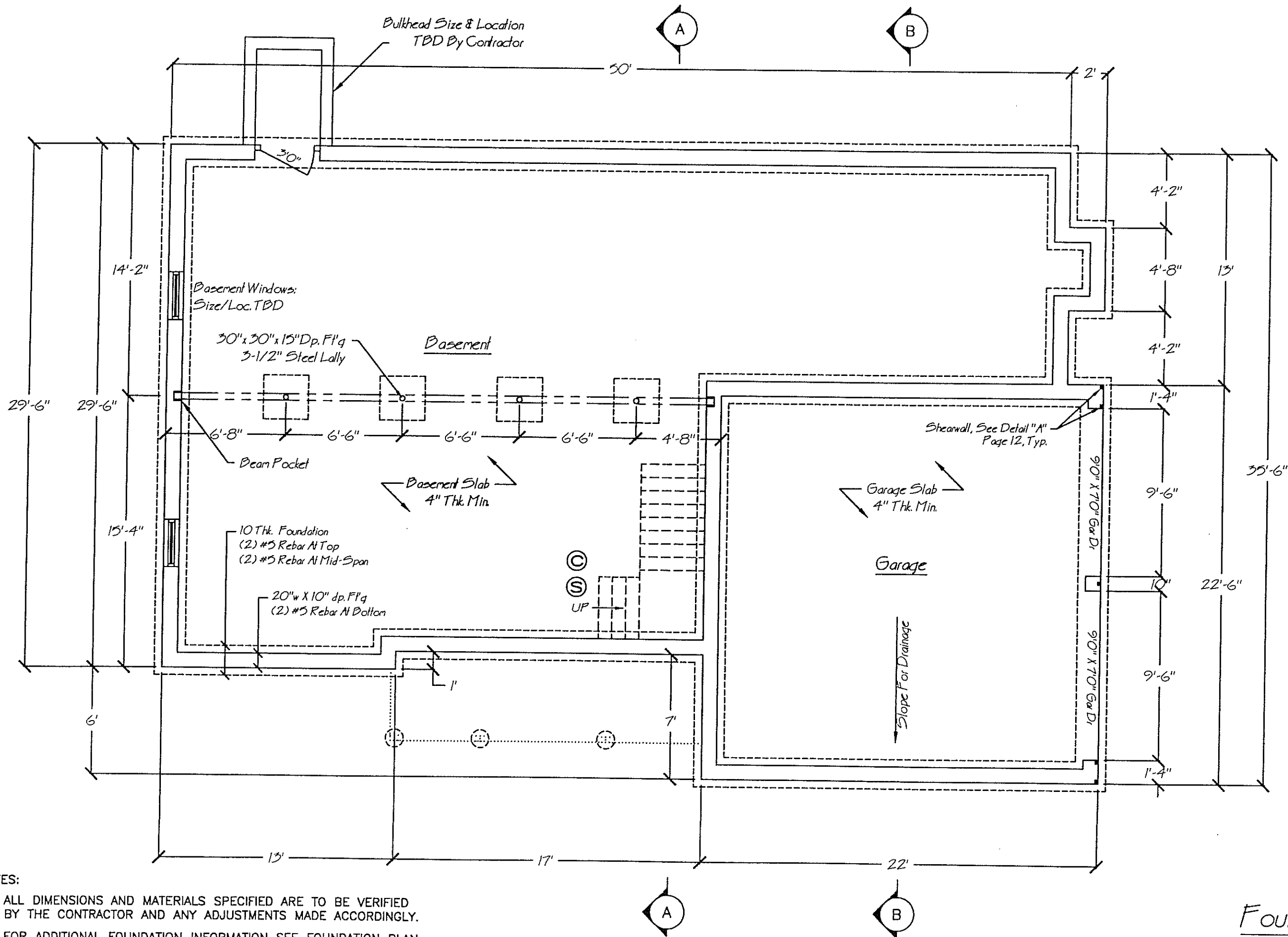

- NOTES:
1. ALL DIMENSIONS AND MATERIALS SPECIFIED ARE TO BE VERIFIED BY THE CONTRACTOR AND ANY ADJUSTMENTS MADE ACCORDINGLY.
 2. FOR ADDITIONAL FOUNDATION INFORMATION SEE FOUNDATION PLAN.

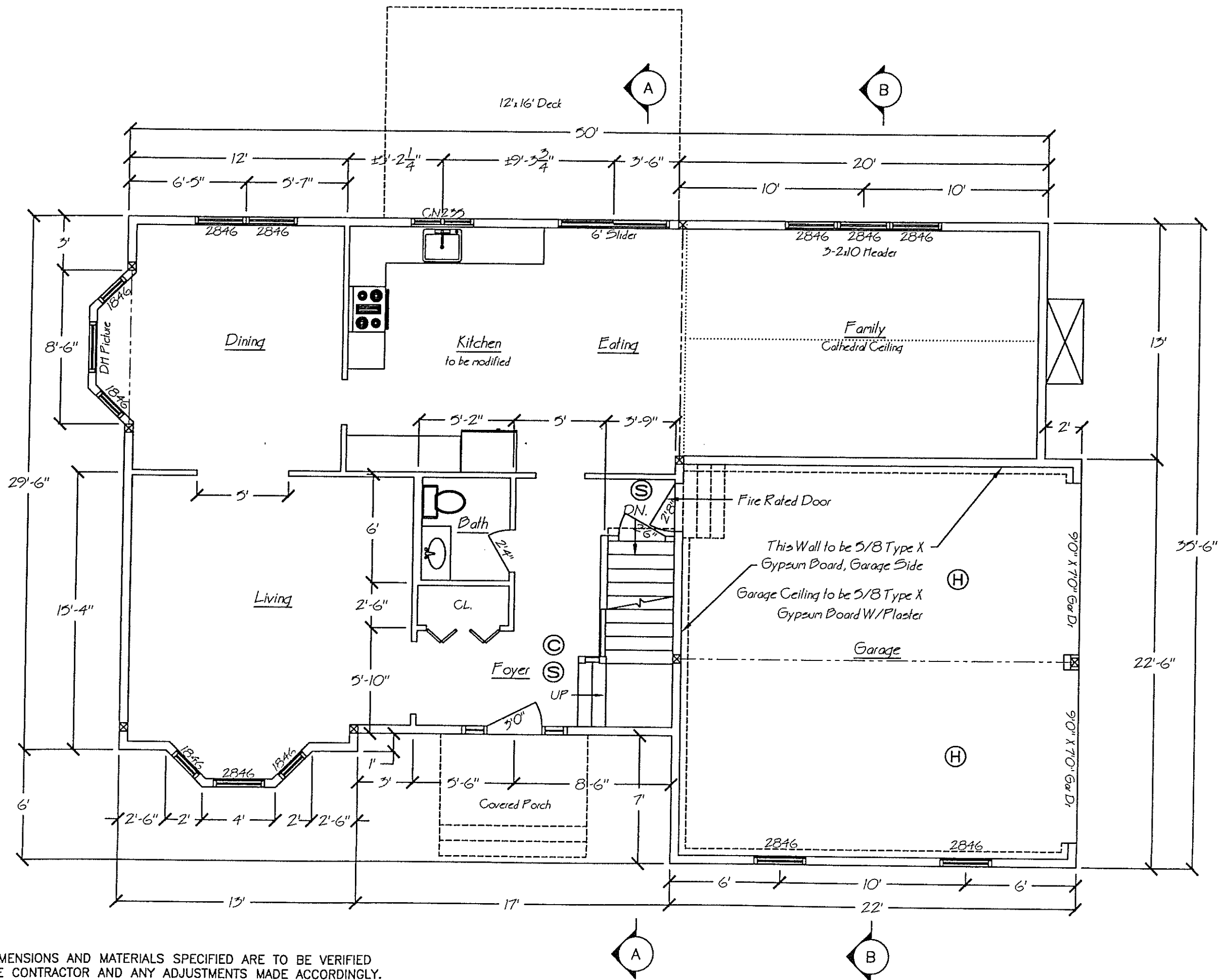

NOTES:

1. ALL DIMENSIONS AND MATERIALS SPECIFIED ARE TO BE VERIFIED BY THE CONTRACTOR AND ANY ADJUSTMENTS MADE ACCORDINGLY.

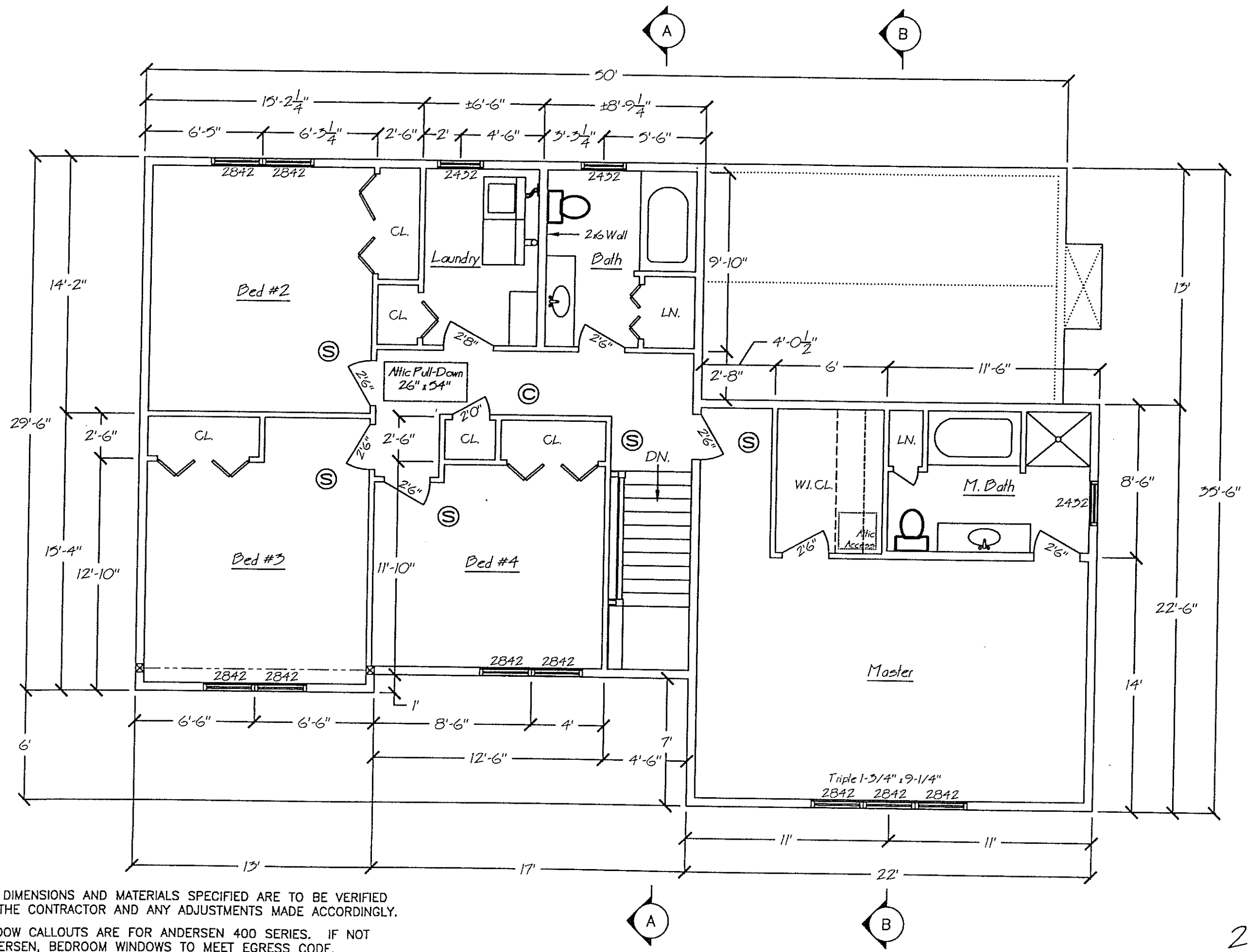

- NOTES:
1. ALL DIMENSIONS AND MATERIALS SPECIFIED ARE TO BE VERIFIED BY THE CONTRACTOR AND ANY ADJUSTMENTS MADE ACCORDINGLY.
 2. WINDOW CALLOUTS ARE FOR ANDERSEN 400 SERIES. IF NOT ANDERSEN, BEDROOM WINDOWS TO MEET EGRESS CODE.

2nd Floor Layout (5)
SCALE: 3/16"=1'

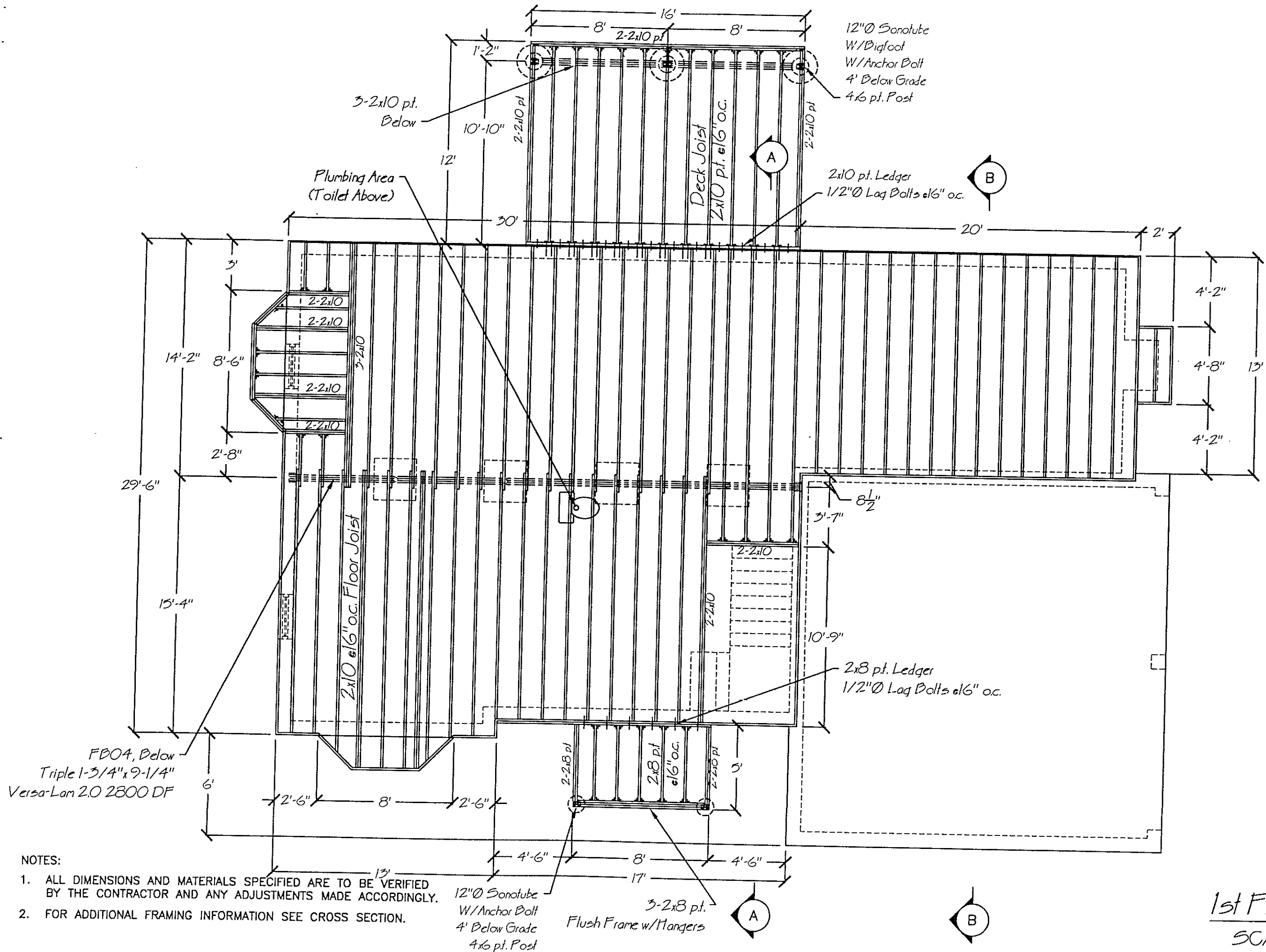

NOTES:

1. ALL DIMENSIONS AND MATERIALS SPECIFIED ARE TO BE VERIFIED BY THE CONTRACTOR AND ANY ADJUSTMENTS MADE ACCORDINGLY.
2. FOR ADDITIONAL FRAMING INFORMATION SEE CROSS SECTION.

12"Ø Sonotube
W/Anchor Bolt
4' Below Grade
4x6 pt. Post

3-2x8 pt.
Flush Frame w/ Mangers

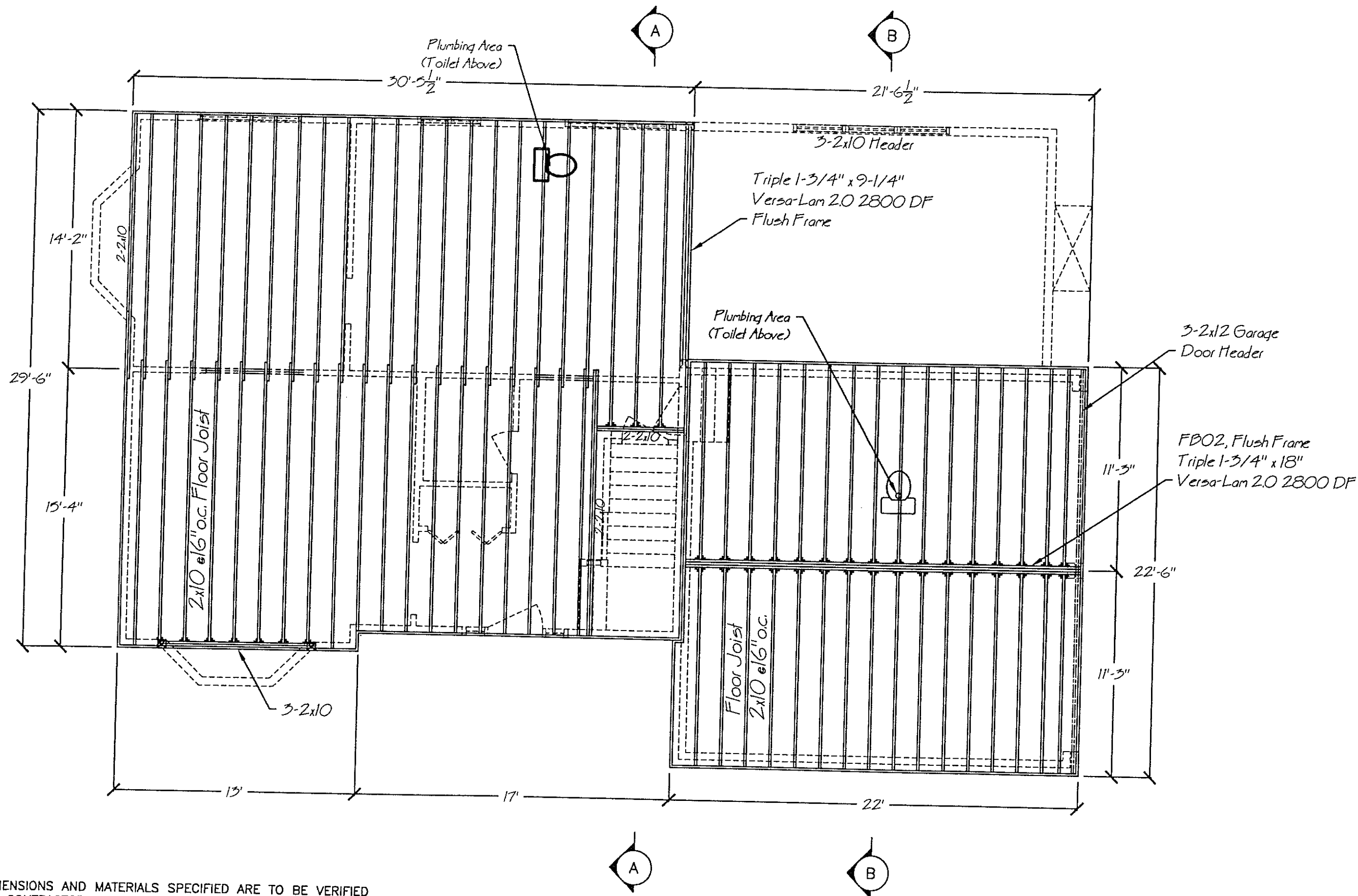

NOTES:

1. ALL DIMENSIONS AND MATERIALS SPECIFIED ARE TO BE VERIFIED BY THE CONTRACTOR AND ANY ADJUSTMENTS MADE ACCORDINGLY.
2. FOR ADDITIONAL FRAMING INFORMATION SEE CROSS SECTION.

2nd Floor Framing ⑦
 SCALE: 3/16" = 1'

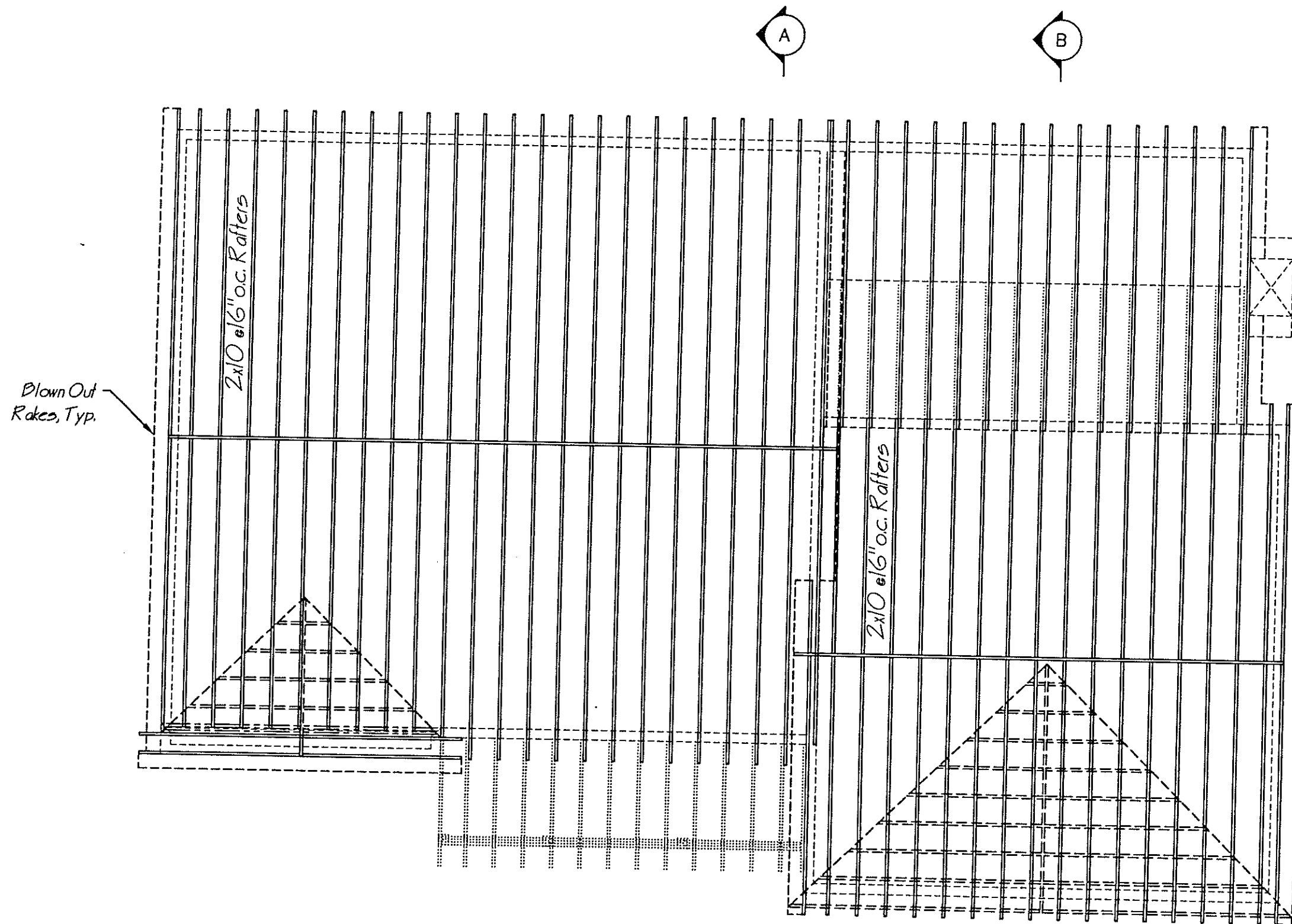

NOTES:

1. ALL DIMENSIONS AND MATERIALS SPECIFIED ARE TO BE VERIFIED BY THE CONTRACTOR AND ANY ADJUSTMENTS MADE ACCORDINGLY.
2. FOR ADDITIONAL FRAMING INFORMATION SEE CROSS SECTION.

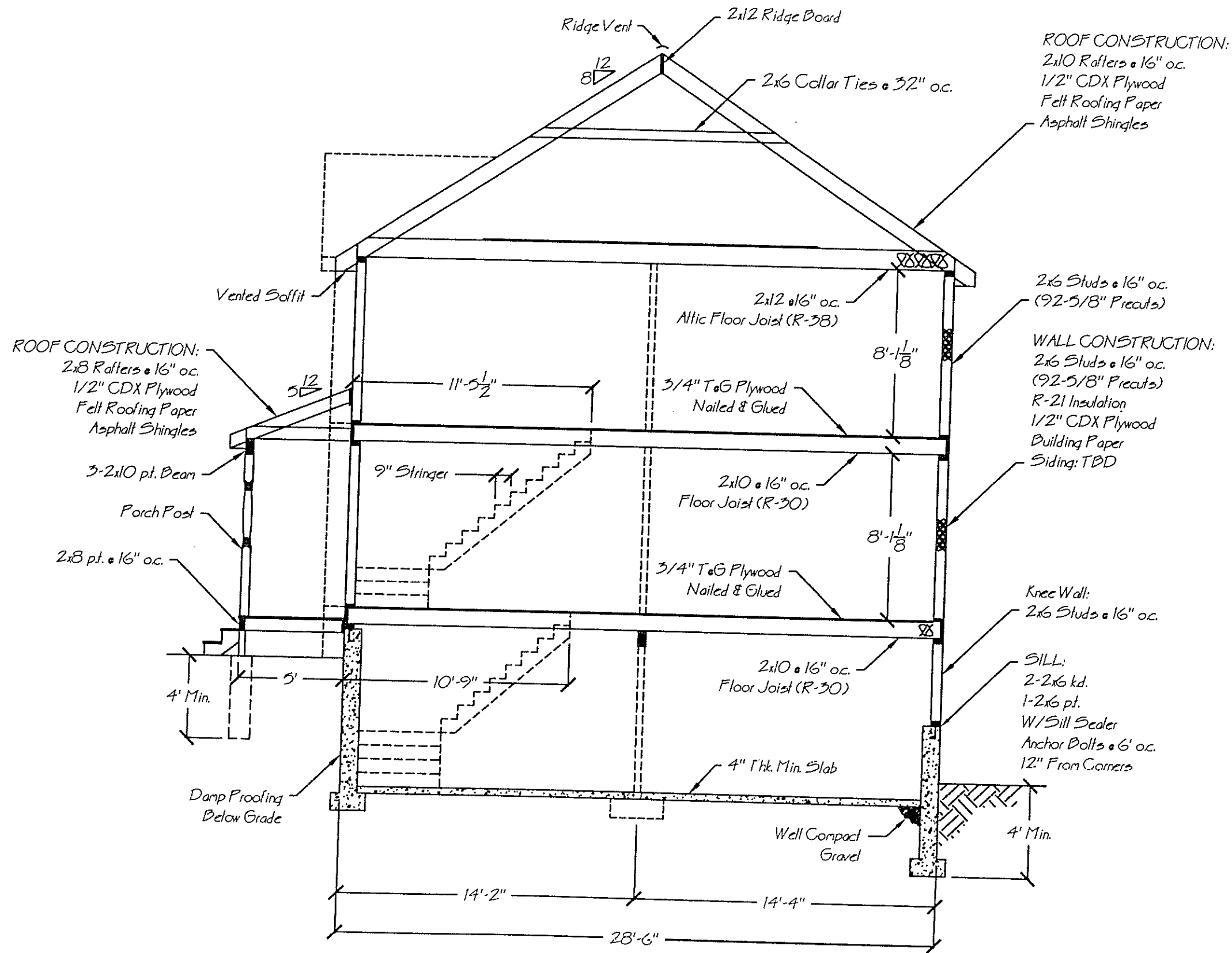

NOTES:

1. ALL DIMENSIONS AND MATERIALS SPECIFIED ARE TO BE VERIFIED BY THE CONTRACTOR AND ANY ADJUSTMENTS MADE ACCORDINGLY.
2. FOR ADDITIONAL FRAMING INFORMATION SEE FRAMING PLAN.

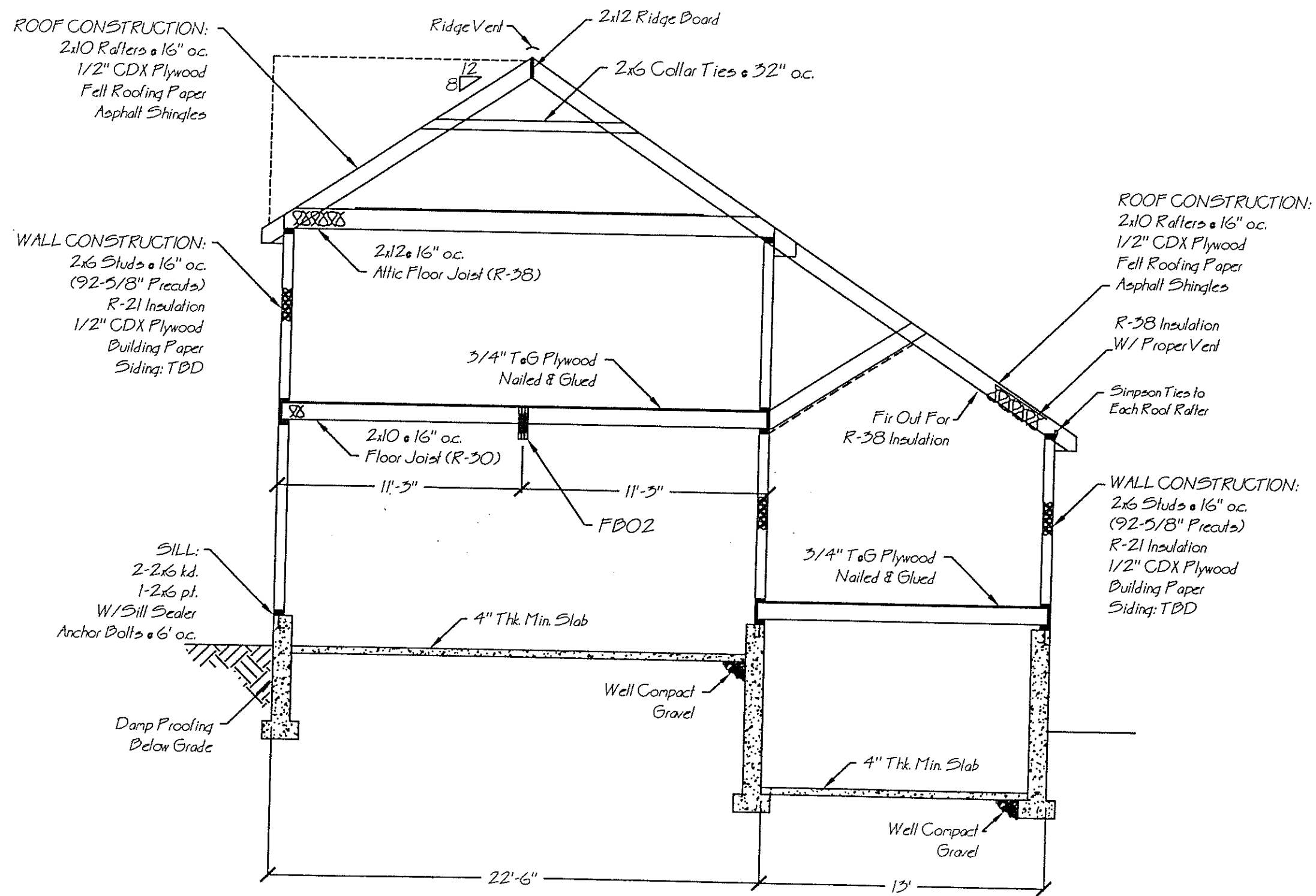

NOTES:

1. ALL DIMENSIONS AND MATERIALS SPECIFIED ARE TO BE VERIFIED BY THE CONTRACTOR AND ANY ADJUSTMENTS MADE ACCORDINGLY.
2. FOR ADDITIONAL FRAMING INFORMATION SEE FRAMING PLAN.